



29 Simpkins Court, Chandlers Ford, SO53 1AL

£1,250 Per Calendar Month

A modern purpose built first floor apartment presented in excellent order throughout, benefiting from sitting room with balcony, kitchen/breakfast room, master bedroom with en-suite, second bedroom and bathroom. The property sits in communal grounds and benefits from one allocated parking space.

ACCOMMODATION

Ground Floor:

Communal Entrance Hall

Stairs and lift to all floors

First Floor

Entrance Hall:

Built in storage cupboard.

Sitting Room:

15'2" x 12'8" (4.62m x 3.86m) Doors to balcony.

Kitchen/Breakfast Room:

12'4" x 7'6" (3.76m x 2.29m) Built in oven, built in four ring gas hob, integrated extractor hood, fridge freezer, dishwasher, integrated washer/dryer, wall mounted boiler, space for table and chairs.

Bedroom 1:

12'5" x 10'2" (3.78m x 3.10m)

En-Suite:

6'5" x 5'10" (1.96m x 1.78m) White suite with chrome fittings comprising shower in cubicle, wash hand basin, WC.

Bedroom 2:

12'5" x 8'3" (3.78m x 2.51m)

Bathroom:

6'7" x 6'7" (2.01m x 2.01m) White suite with chrome fittings comprising bath, wash hand basin, WC.

OUTSIDE

Communal Grounds:

The property sits within communal grounds which benefit from security entry vehicular and pedestrian gates

Parking:

Number 29 benefits from one allocated parking space which is numbered.

OTHER INFORMATION

Approximate Area:

71sqm/764sqft (Details taken from EPC)

Management:

Tenant Find Only

Deposit:

£1442

Availability:

16th April 2024

Pets:

No

heating:

Gas central heating

Windows:

UPVC double glazing

Infant/Junior School:

Hiltingbury Infant/Junior School

Secondary School:

Thornden Secondary School

Local Council:

Eastleigh Borough Council 02380 688000

Council Tax:

Band C

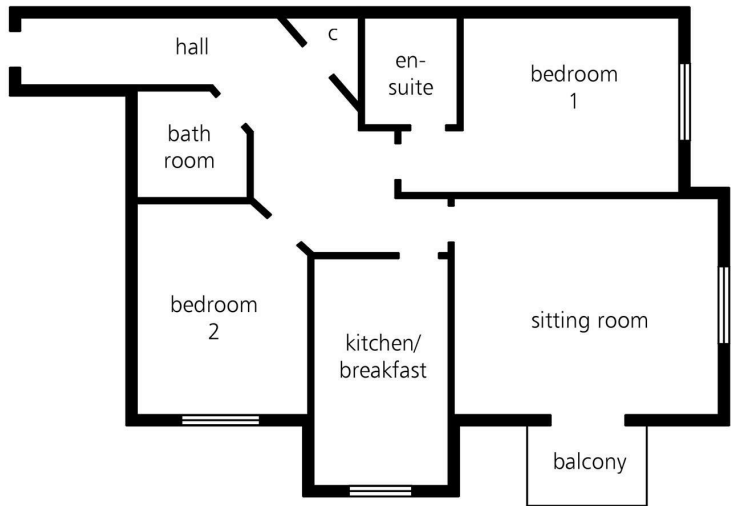

illustrative purposes only



Energy Efficiency Rating		
	Current	Potential
Very energy efficient - lower running costs		
(92 plus) A		
(81-91) B	81	83
(69-80) C		
(55-68) D		
(39-54) E		
(21-38) F		
(1-20) G		
Not energy efficient - higher running costs		
England & Wales	EU Directive 2002/91/EC	

94 Winchester Road, Chandler's Ford, Hampshire, SO53 2GJ

Sales: t: 02380 255333 e: property@sparksellison.co.uk

Lettings: t: 02380 018518 e: lettings@sparksellison.co.uk



While we endeavour to make our sales particulars fair, accurate and reliable, they are only a general guide to the property and, accordingly, if there is any point which is of particular importance to you please contact the office and we will be pleased to check it for you, especially if you are contemplating travelling some distance to view the property. These approximate room sizes are only intended as general guidance. You must verify the dimensions carefully before ordering carpets or any built in furniture. Please note we have not tested the services or any of the equipment or appliances in this property, accordingly we strongly advise prospective buyers to commission their own survey or service report before finalising their offer to purchase. These particulars are issued in good faith but do not constitute representations of fact or form part of any offer or contract. The matters referred to in these particulars should be independently verified by prospective buyers or tenants. Neither Sparks Ellison nor any of its employees or agents has any authority to make or give any representation or warranty whatever in relation to this property. Your home is at risk if you do not keep up repayments on a mortgage or other loan secured on it. Written quotations available on request. All loans secured on property. Life assurance usually required.

