



sparks ellison

Silver Birch Hook Crescent, Parish of Ampfield, SO51 9DE

£1,450,000

A magnificent detached family home set within an impressive mature plot measuring approximately 0.73 acres. This is a truly impressive home providing extensive accommodation including 6 bedrooms, 4 bathrooms and a comprehensive expanse of living accommodation including a wonderful open plan room at the rear of the property that provides the kitchen, dining and family area. This opens onto a great decking area that overlooks the stunning garden. Here you will find a swimming pool, patio areas, large expanse of lawn and mature plants and trees. Hook Crescent is beautifully situated providing a semi rural feel and offering easy access to Winchester, Romsey and Chandler's Ford.

ACCOMMODATION

GROUND FLOOR

Reception Hall:

Stairs to first floor, built in coats cupboard, under stairs storage cupboard.

Cloakroom:

6'3" max x 5'8" max (1.91m max x 1.73m max) Comprising wash hand basin, WC.

Study:

9'6" max x 6'10" max (2.90m max x 2.08m max) Fitted with a comprehensive range of office furniture.

Snug:

15'5" x 13'3" (4.70m x 4.04m)

Sitting Room:

25'4" x 18'9" (7.72m x 5.72m) Feature fireplace surround and hearth with log burner.

Kitchen:

23'9" x 11' (7.24m x 3.35m) An impressive Mike Taylor designed hand painted kitchen comprising built in hide and slide oven, built in micro combi oven, built in warmer drawer, built in induction hob, fitted extractor hood, integrated dishwasher, central island incorporating breakfast bar, space for fridge freezer.

Dining/Family Room:

21'2" x 15' (6.45m x 4.57m) Two sets of triple glazed bi fold doors leading onto decking area overlooking the rear garden.

Utility Room:

6'9" max x 6'9" max (2.06m max x 2.06m max) Space and plumbing for washing machine, space for tumble dryer, built in storage cupboard.

Wet Room:

10'5" x 4'9" (3.18m x 1.45m) Comprising shower area, wash hand basin, WC.

Games Room:

14'6" x 13'7" (4.42m x 4.14m) Created by dividing the garage. Boiler in cupboard.

FIRST FLOOR

Landing:

Access to loft space.

Bedroom 1:

18'9" x 16'3" (5.72m x 4.95m)

Dressing Room:

8'8" x 8'7" (2.64m x 2.62m) Fitted with furniture incorporating hanging, shelving and drawer space.

En Suite:

9'2" x 8'9" (2.79m x 2.67m) Comprising open ended shower enclosure, bath, wash hand basin with cupboard under, WC.

Bedroom 2:

19'4" x 15' (5.89m x 4.57m) Built in cupboards.

Bedroom 3:

15'1" max x 13'11" plus bay (4.60m max x 4.24m plus bay)

Jack And Jill Shower Room:

8' x 4'4" (2.44m x 1.32m) Comprising shower in cubicle, wash hand basin with cupboard under, WC.

Bedroom 4:

13'9" plus bay x 12'8" max (4.19m plus bay x 3.86m max)

Bedroom 5:

11'5" x 10'1" (3.48m x 3.07m) Fitted wardrobe.

Bedroom 6:

15'8" x 7'5" (4.78m x 2.26m)

Bathroom:

10'3" x 7'4" (3.12m x 2.24m) Comprising bath, shower in cubicle, wash hand basin, WC.

OUTSIDE

Front:

Silver Birch owns the driveway that provides access to the property as well as serving three other properties. There is a gravel parking area opposite the house providing parking

as well as an area to the immediate front of the property. Area laid to lawn, planted beds, side access to rear garden.

Rear Garden:

A real feature of the property providing a wonderful outlook and superb space for enjoying and entertaining. There is a large expanse of lawn, area laid to composite deck surrounding the property, paved patio area where there is also an outdoor swimming pool, further paved patio area, planted beds, patio area that currently holds the hot tub, variety of mature plants, bushes, shrubs and trees.

Garage:

14'10" x 4'6" (4.52m x 1.37) With up and over door. This is currently for storage only with the rear providing the family room.

OTHER INFORMATION

Tenure:

Freehold

Approximate Age:

1970

Approximate Area:

395.9sqm/4262sqft (Including outbuildings)

Sellers Position:

No forward chain

Heating:

Gas central heating and underfloor heating

Windows:

UPVC double glazed windows. Triple glazed bi-fold doors and windows to dining/family room

Loft Space:

Partially boarded with light and ladder connected

Infant/Junior School:

Hiltingbury Infant/Junior School

Secondary School:

Thornden Secondary School

Council Tax:

Band G

Local Council:

Test Valley Borough Council - 01264 368000



Ground Floor = 2113 sq ft / 196.2 sq m
 First Floor = 1728 sq ft / 160.5 sq m
 Outbuildings = 421 sq ft / 39.1 sq m
 Limited Use Area(s) = 24 sq ft / 2.2 sq m
 Total = 4262 sq ft / 395.9 sq m
 For identification only - Not to scale



Denotes restricted head height

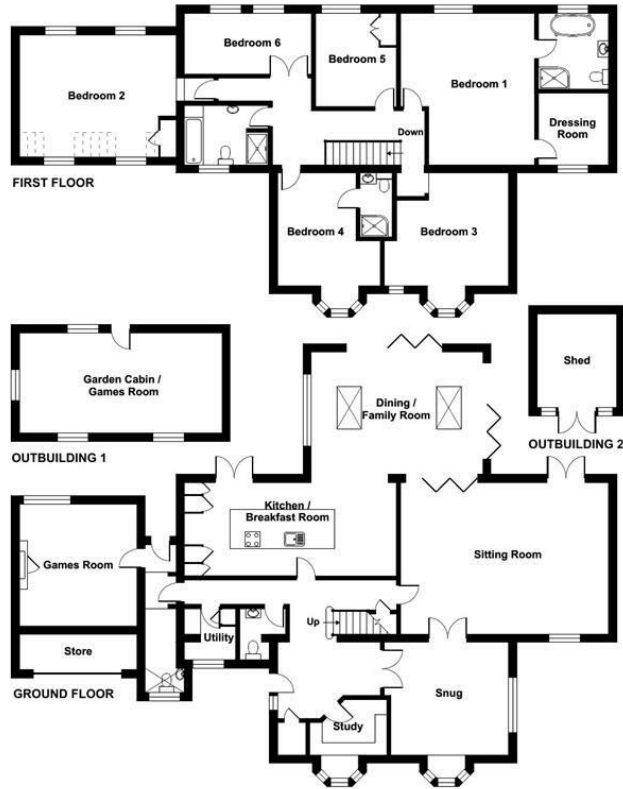

Energy Efficiency Rating		
	Current	Potential
Very energy efficient - lower running costs		
(92 plus) A		
(81-91) B		
(69-80) C		
(55-68) D		
(39-54) E		
(21-38) F		
(1-20) G		
Not energy efficient - higher running costs		
England & Wales	68	78
	EU Directive 2002/91/EC	

Floor plan produced in accordance with RICS Property Measurement Standards incorporating International Property Measurement Standards (IPMS2 Residential). © richcom 2024. Produced for Sparks Ellison. REF: 1125223

94 Winchester Road, Chandler's Ford, Hampshire, SO53 2GJ

Sales: t: 02380 255333 e: property@sparksellison.co.uk
 Lettings: t: 02380 018518 e: lettings@sparksellison.co.uk

While we endeavour to make our sales particulars fair, accurate and reliable, they are only a general guide to the property and, accordingly, if there is any point which is of particular importance to you please contact the office and we will be pleased to check it for you, especially if you are contemplating travelling some distance to view the property. These approximate room sizes are only intended as general guidance. You must verify the dimensions carefully before ordering carpets or any built in furniture. Please note we have not tested the services or any of the equipment or appliances in this property, accordingly we strongly advise prospective buyers to commission their own survey or service report before finalising their offer to purchase. These particulars are issued in good faith but do not constitute representations of fact or form part of any offer or contract. The matters referred to in these particulars should be independently verified by prospective buyers or tenants. Neither Sparks Ellison nor any of its employees or agents has any authority to make or give any representation or warranty whatever in relation to this property. Your home is at risk if you do not keep up repayments on a mortgage or other loan secured on it. Written quotations available on request. All loans secured on property. Life assurance usually required.



