



Cumberland Close



sparks ellison

21 Cumberland Close, Chandler's Ford, SO53 2JY

£389,950

An exceptionally well presented three bedroom semi-detached home situated in a quiet cul-de-sac on the Eastern side of Chandler's Ford and within walking distance to local schools as well as Fryern Recreation Ground and the centre of Chandler's Ford. The property is presented to an exceptionally high standard throughout affording a host of wonderful attributes to include a re-fitted kitchen/dining room, re-fitted bathroom, new internal doors, brick paved driveway and landscaped rear garden affording a pleasant Southerly aspect.

ACCOMMODATION

Ground Floor

Open Porch:

Modern replacement front door to reception hall.

Reception Hall:

Stairs to first floor with cupboard under.

Sitting Room:

14'10" x 11'6" (4.52m x 3.51m) Log burner.

Kitchen/Dining Room:

14'10" x 8'7" (4.52m x 2.62m) Re-fitted matt grey units with wooden worktops over, electric double oven/combination microwave, induction hob with extractor hood over, integrated bins and washing machine, integrated fridge/freezer, breakfast bar, space for table and chairs, double doors to rear garden.

First Floor

Landing:

Hatch to loft space.

Bedroom 1:

15' x 8'9" (4.57m x 2.67m) Double wardrobe.

Bedroom 2:

8'5" x 8'2" (2.57m x 2.49m) Double cupboard with storage and boiler.

Bedroom 3:

11'7" x 6'1" (3.53m x 1.85m)

Bathroom:

8'2" x 5'6" (2.49m x 1.68m) Re-fitted modern white suite comprising P shaped bath with shower unit over and glazed screen, wash basin with cupboards under, wc and wooden counter top.

OUTSIDE

Front:

To the front of the property is a good sized brick paved driveway affording off street parking with adjacent lawned area, side gate to rear garden.

Rear Garden:

Approximately 40' x 23'. Affording a pleasant Southerly aspect and landscaped with patio adjoining the house, two rendered raised planters, step down to further lawned area enclosed by modern fencing, shed, outside taps and power.

OTHER INFORMATION

Tenure:

Freehold

Approximate Age:

1960's

Approximate Area:

73.6sqm/792sqft

Sellers Position:

Looking for forward purchase

Heating:

Gas central heating

Windows:

UPVC double glazing

Infant/Junior School:

Fryern Infant / Junior School

Secondary School:

Toynbee Secondary School

Local Council:

Eastleigh Borough Council - 02380 688000

Council Tax:

Band C

Ground Floor = 391 sq ft / 36.3 sq m
 First Floor = 401 sq ft / 37.3 sq m
 Total = 792 sq ft / 73.6 sq m
 For identification only - Not to scale

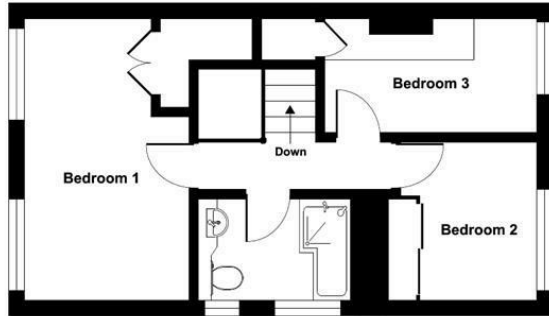

FIRST FLOOR

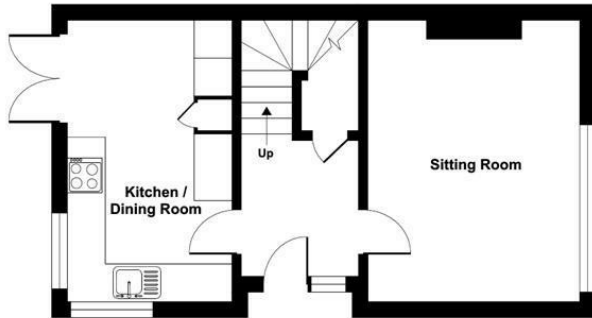

GROUND FLOOR



Energy Efficiency Rating		Current	Potential
Very energy efficient - lower running costs			
(92 plus) A			84
(81-91) B			
(69-80) C			
(55-68) D		64	
(39-54) E			
(21-38) F			
(1-20) G			
Not energy efficient - higher running costs			
England & Wales		EU Directive 2002/91/EC	

Floor plan produced in accordance with RICS Property Measurement 2nd Edition, Incorporating International Property Measurement Standards (IPMS2 Residential). © ritchcom 2025. Produced for Sparks Ellison. REF: 1236317

94 Winchester Road, Chandler's Ford, Hampshire, SO53 2GJ

Sales: t: 02380 255333 e: property@sparksellison.co.uk

Lettings: t: 02380 018518 e: lettings@sparksellison.co.uk

While we endeavour to make our sales particulars fair, accurate and reliable, they are only a general guide to the property and, accordingly, if there is any point which is of particular importance to you please contact the office and we will be pleased to check it for you, especially if you are contemplating travelling some distance to view the property. These approximate room sizes are only intended as general guidance. You must verify the dimensions carefully before ordering carpets or any built in furniture. Please note we have not tested the services or any of the equipment or appliances in this property, accordingly we strongly advise prospective buyers to commission their own survey or service report before finalising their offer to purchase. These particulars are issued in good faith but do not constitute representations of fact or form part of any offer or contract. The matters referred to in these particulars should be independently verified by prospective buyers or tenants. Neither Sparks Ellison nor any of its employees or agents has any authority to make or give any representation or warranty whatever in relation to this property. Your home is at risk if you do not keep up repayments on a mortgage or other loan secured on it. Written quotations available on request. All loans secured on property. Life assurance usually required.



