



70 Whyteways, Boyatt Wood, SO50 4NR

£275,000

An exceptionally well presented two bedroom terraced property situated in the popular Boyatt Wood and close to a generous array of local amenities. The property would be ideal for first time buyers and investors. This spacious two bedroom house boasts a contemporary interior, featuring a newly fitted bathroom and recently laid carpets on the stairs and landing. Externally the property enjoys an attractive garden along with a single garage. There are also four shared parking spaces nearby.

ACCOMMODATION

GROUND FLOOR

Entrance Hall:

9' (2.74m) Under stair cupboard and stairs leading to the first floor.

Kitchen:

6'6" x 9' (1.98m x 2.74m) Range of units with space for fridge freezer, space for washing machine space for cooker.

Sitting/Dining Room:

15' x 12'3" (4.57m x 3.73m) Patio doors leading to garden.

FIRST FLOOR

Landing:

Access to loft space.

Bedroom 1:

12'3" x 9'5" (3.73m x 2.87m)

Bedroom 2:

9'5" x 8' (2.87m x 2.44m) Cupboard over stairs.

Bathroom:

6'5" x 6'4" (1.96m x 1.93m) Re-fitted suite comprising bath with shower over with rainfall shower head, wash hand basin with drawers under, w.c. tiled floor.

OUTSIDE

Front:

Laid to lawn with pathway to front door, outside storage cupboard.

Rear Garden:

Measuring 31 ft including large shed at the back of the garden.

Garage:

16'2" x 7'10" (4.93m x 2.39m) Located in a nearby block.

OTHER INFORMATION

Tenure:

Freehold

Approximate Age:

1970's

Approximate Area:

57sqm/614sqft

Sellers Position:

Looking for forward purchase

Heating:

Gas central heating

Windows:

UPVC double glazed windows

Loft Space:

Partially boarded

Infant/Junior School:

Shakespeare Infant/Junior School

Secondary School:

Crestwood Community School

Council Tax:

Band B

Local Council:

Eastleigh Borough Council - 02380 688000

Agents Note:

If you have an offer accepted on a property we will need to, by law, conduct Anti Money Laundering Checks. There is a charge of £20 + vat per person for these checks.



Ground Floor = 307 sq ft / 28.5 sq m
 First Floor = 307 sq ft / 28.5 sq m
 Total = 614 sq ft / 57 sq m
 For identification only - Not to scale

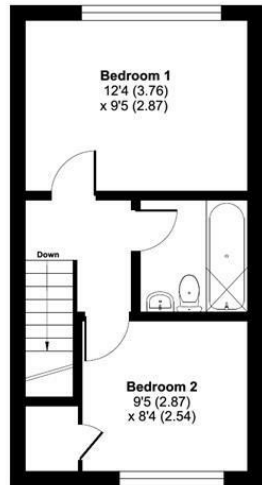

FIRST FLOOR

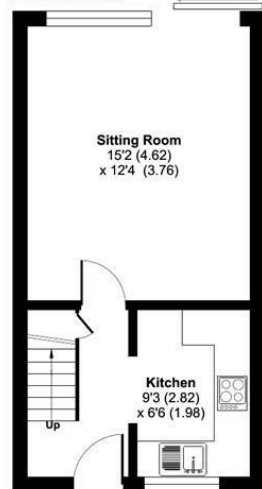

GROUND FLOOR



Energy Efficiency Rating		
	Current	Potential
Very energy efficient - lower running costs		
(92 plus) A		87
(81-91) B		
(69-80) C	72	
(55-68) D		
(39-54) E		
(21-38) F		
(1-20) G		
Not energy efficient - higher running costs		
England & Wales	EU Directive 2002/91/EC	

Floor plan produced in accordance with RICS Property Measurement 2nd Edition, Incorporating International Property Measurement Standards (IPMS2 Residential). © nrichecom 2025. Produced for Sparks Ellison. REF: 1237956

94 Winchester Road, Chandler's Ford, Hampshire, SO53 2GJ

Sales: t: 02380 255333 e: property@sparksellison.co.uk

Lettings: t: 02380 018518 e: lettings@sparksellison.co.uk

While we endeavour to make our sales particulars fair, accurate and reliable, they are only a general guide to the property and, accordingly, if there is any point which is of particular importance to you please contact the office and we will be pleased to check it for you, especially if you are contemplating travelling some distance to view the property. These approximate room sizes are only intended as general guidance. You must verify the dimensions carefully before ordering carpets or any built in furniture. Please note we have not tested the services or any of the equipment or appliances in this property, accordingly we strongly advise prospective buyers to commission their own survey or service report before finalising their offer to purchase. These particulars are issued in good faith but do not constitute representations of fact or form part of any offer or contract. The matters referred to in these particulars should be independently verified by prospective buyers or tenants. Neither Sparks Ellison nor any of its employees or agents has any authority to make or give any representation or warranty whatever in relation to this property. Your home is at risk if you do not keep up repayments on a mortgage or other loan secured on it. Written quotations available on request. All loans secured on property. Life assurance usually required.



